

CATALOG
2016

MEIJER

HANDLING SOLUTIONS

KOOI REACHFORKS[®]

KOOI EQUIPMENT[®]

KOOI PALLETLESS[®]

KOOI SYSTEMS[®]

Meijer Handling Solutions aims to add value to our customers' and end-users' logistical supply chains. We are the world's market leader in hydraulic lift truck forks, known as KOOL-REACHFORKS®. Also, we are known for our palletless handling attachments such as the patented ROLLERFORKS® and our unique PushPull systems. The latest product to be introduced to the market is the Stationary Pull Installation, a stand-alone 'Push/Pull' to transfer goods from one load carrier onto another load carrier.

Decades of experience in the material handling industry combined with a highly skilled support staff has allowed Meijer to develop the intelligence and necessary, (technical), know-how in order

to provide the best advice, service and support concerning your logistics issues. From forklift attachments to complex customer-specific solutions,

Meijer Handling Solutions KNOWS WHAT TO DO!



HENDRIK MEIJER



TABLE OF CONTENTS

Table of contents	
Category	Page Number
KOOI-REACHFORKS	
Hydraulic KOOI-REACHFORKS®	4
- Double deep stacking	5
- One-sided loading and unloading	6
- Multi-pallet handling	7
- Hydraulic fork extensions	8
- Heavy-duty applications	9
- Options	10 - 11
Manual KOOI-REACHFORKS®	12
Loose Forks Extensions	14
KOOI-ATTACHMENTS	
Mast Height Extension	16
Single Heights Shift Systems	18
KOOI-PALLETLESS	
ROLLERFORKS®	20
Push-Pulls	22
ROLLERFORKS Push-Pulls	24
Rollerized Tine Extenders	26
KOOI-PALLET TRANSFER	
Stationary Pallet Changer	28
Stationary Pull Installation	30

Meijer Handling Solutions is the original inventor of the hydraulic extendable forks, and with more than 35 years of experience and thousands of satisfied customers, the KOOI-REACHFORKS® have become the benchmark in materials handling. With one and two cylinders in each fork and an integrated synchronization system, Meijer Handling Solutions guarantees you the best telescopic fork on the market.

KOOI-REACHFORKS® can be used for one-sided loading/unloading, double deep stacking, multi-pallet handling and as extension forks.

It is even possible to fit the telescopic forks with cameras to aid overhead pallet stacking.

KOOI-REACHFORKS® offer the following advantages:

- Speed up (un)loading time by around 25%.
- Improve space utilization, gain 30% or more storage space.
- Cut internal transport costs by 50%.
- Reduce damages to both goods and pallets.



Double-deep stacking
Page 5



One-sided (un)loading
Page 6



Multi-pallet handling
Page 7



Dual pallet handling
Page 8



Heavy-duty applications
Page 9



Options
Page 10/11

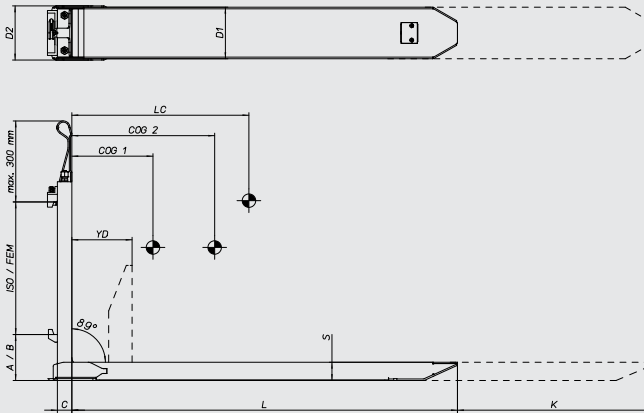

Double-deep stacking:

Mainly used on reachtrucks for double-deep stacking in warehouses.

- Increases warehouse capacity up to 30%

Single Range

Model	Capacity on LC 600 mm (kg)	Section D1/D2xS (mm)	L / K (mm)	C (mm)	CoG1 (mm)	CoG2 (mm)	Weight (kg)	ISO/FEM
RG2 20 1100/0750	2000	131/139 x 57	1100/0750	45	370	530	147	2A
RG2 20 1200/0850			1200/0850		415	600	156	
RG2 20 1350/1000			1350/1000		480	710	170	
RG2 30 1100/0750	3000	131/139 x 57	1100/0750	45	350	508	157	3A
RG2 30 1200/0850			1200/0850		395	580	166	
RG2 30 1350/1000			1350/1000		460	680	180	
RGN2 35 1100/0750	3500	131/139 x 62	1100/0750	50	355	500	172	3A
RGN2 35 1200/0850			1200/0850		417	590	180	
RGN2 35 1350/1000			1350/1000		463	665	198	
TFG2 30 1050/0800	3000	131 / 139 x 62	1050/0800	50	350	505	168	3A
TFG2 30 1150/0900			1150/0900		390	575	178	
TFG2 30 1300/1050			1300/1050		455	680	193	
TRG2 30 0950/0900	3000	170/179 x 67	095/0900	50	267	412	182	3A
TRG2 30 1050/1000			1050/1000		356	553	213	
TRG2 30 1200/1150			1200/1150		448	698	243	

- Minimum operating pressure 10 MPa, maximum 25 MPa.
- Type RG delivered including one hydraulic hose.
- All forks have a 6 mm thick integrated wear plate (400 HB) under the complete outer sleeves for longer life span.
- For optimal speed and minimum loss of pressure the recommended minimum hose diameter is 8 mm.
- In cold-storage applications KOOI-REACHFORKS® can be used down to -30 degrees Celcius, contact your dealer.
- The lift truck manufacturer must determine the combined KOOI-REACHFORKS® and lift truck capacity.
- Capacities shown are nominal and apply to the forks and not the lift truck. Other capacities and dimensions on request.

KOOI-REACHFORKS®

One-sided loading and unloading

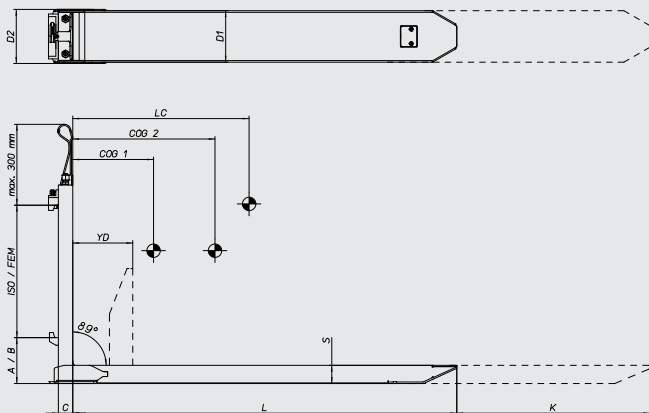

One-sided (un)loading:

Mainly used on counterbalance and side-loader lift trucks for one side loading.

- Saving time up to 25%.
- Reducing fuel extremely.
- Improve safety (remains in sight).

Double range

Model	Capacity on LC 600 mm (kg)	Section D1/D2xS (mm)	L / K (mm)	C (mm)	CoG1 (mm)	CoG2 (mm)	Weight (kg)	ISO/FEM
RG4 25 1100/0750	2500	161/169x57	1100/0750	45	363	536	178	2A
RG4 25 1200/0850			1200/0850		406	607	189	
RG4 25 1350/1000			1350/1000		473	717	206	
RG4 35 1100/0750	3500	161/169x57	1100/0750	45	344	506	189	3A
RG4 35 1200/0850			1200/0850		386	576	200	
RG4 35 1350/1000			1350/1000		451	683	217	
RG4 45 1100/0750	4500	161/169x57	1100/0750	45	344	506	189	3A
RG4 45 1200/0850			1200/0850		386	576	200	
RG4 45 1350/1000			1350/1000		451	683	217	
RG4 58 1100/0750	5800	161/169x62	1100/0750	50	314	449	233	4A
RG4 58 1200/0850			1200/0850		354	512	245	
RG4 58 1350/1000			1350/1000		415	610	264	
RE4 32 1100/0750	3200	161/169x47	1100/0750	45	328	486	176	3A
RE4 32 1200/0850			1200/0850		369	554	185	
RE4 32 1350/1000			1350/1000		433	660	200	

- Minimum operating pressure 10 MPa, maximum 25 MPa.
- Type RE delivered including separate flow divider and four hydraulic hoses. Type RG delivered including one hydraulic hose.
- All forks have a 6 mm thick integrated wear plate (400 HB) under the complete outer sleeves for longer life span.
- For optimal speed and minimum loss of pressure the recommended minimum hose diameter is 8 mm.
- In cold-storage applications KOOI-REACHFORKS® can be used down to -30 degrees Celcius, contact your dealer.
- The lift truck manufacturer must determine the combined KOOI-REACHFORKS® and lift truck capacity.
- Capacities shown are nominal and apply to the forks and not the lift truck. Other capacities and dimensions on request.

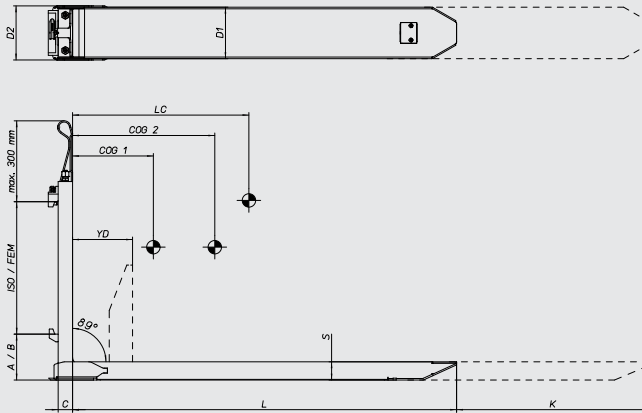

Multi-pallet handling:

Mainly included on multi-pallet handlers.

- Ideal for handling beverage.
- Cut down time for (un)loading.
- Savings on fuel.

Slim range								
Model	Capacity on LC 600 mm (kg)	Section D1/D2xS (mm)	L / K (mm)	C (mm)	CoG1 (mm)	CoG2 (mm)	Weight (kg)	ISO/FEM
RE2 27 1150/0700	2700	89/81x63	1150/0700	60	445	630	106	2A
RE2 27 1250/0800			1250/0800		490	705	113	
RE2 27 1400/0950			1400/0950		565	825	122	
RE2 37 1150/0700	3700	89/81x73	1150/0700	60	415	575	132	3A
RE2 37 1250/0800			1250/0800		465	650	139	
RE2 37 1400/0950			1400/0950		535	755	151	

- Slim Range forks need a minimum overlap of 400 mm (retracted length-stroke).
- Minimum operating pressure 10 MPa, maximum 25 MPa.
- Type RE delivered including separate flow divider and four hydraulic hoses.
- All forks have a 6 mm thick integrated wear plate (400 HB) under the complete outer sleeves for longer life span.
- For optimal speed and minimum loss of pressure the recommended minimum hose diameter is 8 mm.
- In cold-storage applications KOOI-REACHFORKS® can be used down to -30 degrees Celcius, contact your dealer.
- The lift truck manufacturer must determine the combined KOOI-REACHFORKS® and lift truck capacity.
- Capacities shown are nominal and apply to the forks and not the lift truck. Other capacities and dimensions on request.

KOOI-REACHFORKS®

Dual pallet handling

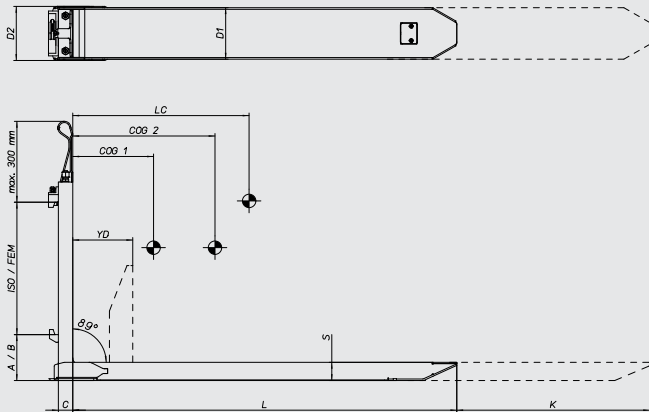

Dual pallet handling:

Mainly on counterbalance and reachtrucks for variable lengths and dual pallet handling.

- Damages of oversized forks will be history!
- Improving handling speed by lifting two pallets.

Extension range

Model	Capacity on LC 600 mm (kg)	Section D1/D2xS (mm)	L / K (mm)	C (mm)	CoG1 (mm)	CoG2 (mm)	Weight (kg)	ISO/FEM
REE 17 0800/0400	1700	128/128x40	0800/0400	40	215	240	90	2A
REE 17 1000/0200			1000/0200		290	310	105	
REE 17 1200/0800			1200/0800		375	495	116	
RGE 20 0800/0400	2000	131/131x57	0800/0400	45	233	293	113	2A
RGE 20 1000/0200			1000/0200		316	340	133	
RGE 20 1200/0800			1200/0800		397	520	145	
RGE 30 0800/0400	3000	131/131x57	0800/0400	45	220	275	122	3A
RGE 30 1000/0200			1000/0200		302	327	144	
RGE 30 1200/0800			1200/0800		382	515	158	

- Minimum operating pressure 10 MPa, maximum 25 MPa.
- Type RE delivered including separate flow divider and four hydraulic hoses. Type RG delivered including one hydraulic hose.
- All forks have a 6 mm thick integrated wear plate (400 HB) under the complete outer sleeves for longer life span.
- For optimal speed and minimum loss of pressure the recommended minimum hose diameter is 8 mm.
- In cold-storage applications KOOI-REACHFORKS® can be used down to -30 degrees Celcius, contact your dealer.
- The lift truck manufacturer must determine the combined KOOI-REACHFORKS® and lift truck capacity.
- Capacities shown are nominal and apply to the forks and not the lift truck. Other capacities and dimensions on request.

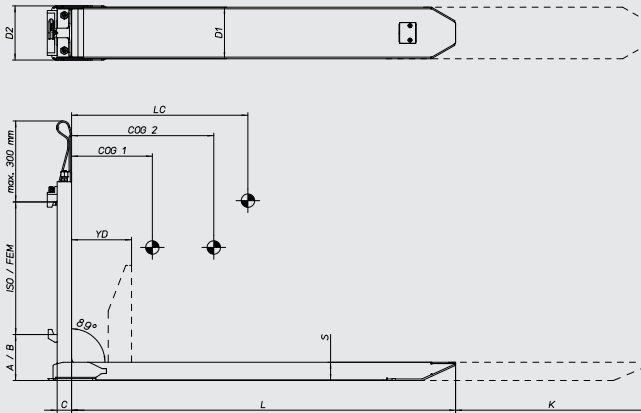

Heavy-duty applications:

Ideal for handling timber, concrete, sea containers and more.

- For extreme capacities up to 110,000 Lbs.

Heavy duty range - for extreme capacities

Model	Capacity on LC 600 mm (kg)	Section D1/D2xS (mm)	L / K (mm)	C (mm)	CoG1 (mm)	CoG2 (mm)	Weight (kg)	ISO/FEM
RG4 77 1100/0750	7700	215/227x68	1100/0750	50	325	485	331	4A
RG4 77 1200/0850			1200/0850		370	555	349	
RG4 77 1350/1000			1350/1000		435	665	376	
RG4 105 1100/0750	10500	215/227x76	1100/0750	60	331	492	392	4A
RG4 105 1200/0850			1200/0850		371	558	413	
RG4 105 1350/1000			1350/1000		433	659	446	
RE4 105 1100/0750	10500	215/227x76	1100/0750	60	315	445	420	5A
RE4 105 1200/0850			1200/0850		360	510	443	
RE4 105 1350/1000			1350/1000		425	610	477	

- Minimum operating pressure 10 MPa, maximum 25 MPa.
- Type RE delivered including separate flow divider and four hydraulic hoses. Type RG delivered including one hydraulic hose.
- All forks have a 6 mm thick integrated wear plate (400 HB) under the complete outer sleeves for longer life span.
- For optimal speed and minimum loss of pressure the recommended minimum hose diameter is 8 mm.
- In cold-storage applications KOOI-REACHFORKS® can be used down to -30 degrees Celcius, contact your dealer.
- The lift truck manufacturer must determine the combined KOOI-REACHFORKS® and lift truck capacity.
- Capacities shown are nominal and apply to the forks and not the lift truck. Other capacities and dimensions on request.

KOOI-REACHFORKS®

Options and accessories

Palletstops (welded on)	
Model	Height (mm)
Y2	200/400
Y3	850/1000/1200/1600
Demountable Y2	



Load backrest (connected on outer forks. including pallet stops Y2)	
Model	Dimensions
Standard	On request
Special	On request



Oil connections	
Possible variations	
Both on top	
One on top and one on the inner side	
One on top and one on the outer side	
On inner and outer side	
Both at the back of the forks	
JIC couplings (for USA)	
90° couplings	

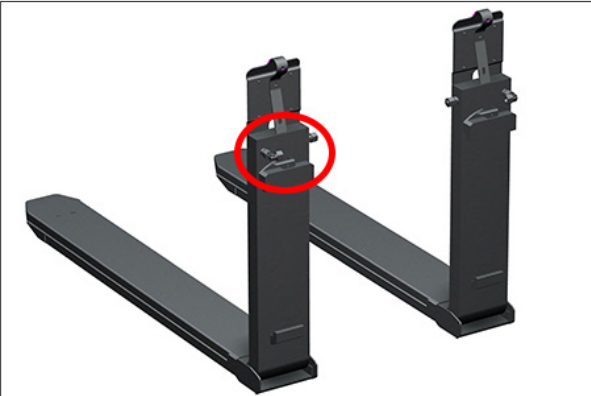

Wear strip (under outer forks, extra thickness ± 5 mm)	
Model	
Extra hardened plate on the underside of the outer forks	
Extra wear strip in fork taper	

Stainless steel forks
(outer forks, pallet stops, heel, side of the inner forks)

Model



Camera

Model



A cheaper alternative for hydraulic KOOI-REACHFORKS® are the patented Manual KOOI-REACHFORKS®. These lift truck forks are extended in length manually. The mechanical movable outer sleeves are secured to the base fork and remain mounted on the forklift truck. These forks offer a lower cost alternative to hydraulic KOOI-REACHFORKS® and they are ideal for companies that don't need fork extensions that frequently, but only come across the need once in a while.

The manner of adjusting the outer sleeve is highly innovative. It simply involves moving a pin (which also serves as a grease nipple) sideways, causing the locker to be retracted. As soon as the locker

is disengaged, the outer sleeve can be moved using the other hand until the locker engages again at the different length.

Manual KOOI-REACHFORKS® offer the following advantages:

- Remain mounted on the forklift truck so they are always available
- Lightweight construction that is easily extended.
- Innovative outer forks which cannot catch on tensioning straps.
- Fast extension in one simple movement.
- No hydraulic parts.
- Low maintenance costs.
- No loose parts.



MANUAL KOOI-REACHFORKS®

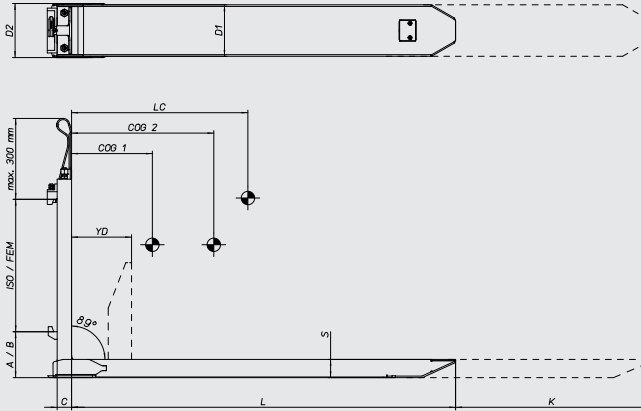

Manual

Ideal for companies that don't need fork extensions that frequently, but only come across the need once in a while.

- Damages of oversized forks will be history!
- Improving handling speed by lifting two pallets.

Manual KOOI-REACHFORKS® including replaceable wearplate								
Model	Capacity on LC 600 mm (kg)	Section D1/D2xS (mm)	L/K (mm)	C (mm)	CoG1 (mm)	CoG2 (mm)	Weight (kg)	ISO/FEM
MME 17 0800/0400	1700	132x41	0800/0400	40	220	245	95	2A
MME 17 0800/0200			0800/0200		220	245	95	
MME 17 1000/0200			1000/0200		295	315	110	
MME 17 1200/0800			1200/0800		380	500	121	
MME 20 0800/0400	2000	132x58	0800/0400	45	235	295	114	2A
MME 20 0800/0200			0800/0200		235	295	114	
MME 20 1000/0200			1000/0200		315	415	131	
MME 20 1200/0800			1200/0800		405	545	150	
MME 20 1400/1000			1400/1000		484	640	161	
MME 24 0800/0200	2400	132x45	0800/0200	45	220	275	104	2A
MME 24 0800/0400			0800/0400		220	275	104	
MME 24 1000/0200			1000/0200		300	325	121	
MME 24 1200/0800			1200/0800		385	515	135	
MME 30 0800/0200	3000	132x58	0800/0200	45	220	275	122	3A
MME 30 0800/0400			0800/0400		220	275	122	
MME 30 1000/0200			1000/0200		300	325	144	
MME 30 1200/0800			1200/0800		390	515	158	
MME 30 1400/1000			1400/1000		470	645	176	
MME 35 0800/0200	3500	132x63	0800/0200	50	230	300	140	3A
MME 35 0800/0400			0800/0400		230	300	140	
MME 35 1000/0200			1000/0200		320	390	160	
MME 35 1200/0800			1200/0800		400	550	183	
MME 35 1400/1000			1400/1000		485	680	205	

- Extra adjustments for in-between position. Type MME including replaceable wearplate under innerforks.
- In cold-storage applications KOOI-REACHFORKS® can be used down to -30 degrees Celcius, contact your dealer.
- The lift truck manufacturer must determine the combined KOOI-REACHFORKS® and lift truck capacity.
- Capacities shown are nominal and apply to the forks and not the lift truck. Other capacities and dimensions on request.

These outer sleeves simply slide over the existing lift truck forks providing additional length of a predetermined size. Usage is recommended for applications with very infrequent need for differing fork length. Fork extensions offer a lightweight design with robust handling ability.

The loose fork extensions of Meijer Handling Solutions have an innovative design that is partially open along its lower surface, but has the characteristics of a closed sleeve. Extensive expertise in the field of bending and sheet metalworking has resulted in loose fork extensions that meet the most stringent quality standards.

The Meijer Handling Solutions fork extensions offer the following advantages:

- Loads can be handled where the load centre (LC) is located beyond the fixed forks' basic length.
- All-round, continuous cross-section without welds.
- Lightweight construction compared to a full sleeve cross-section.
- Profiled, pointed nose for easy pallet insertion..

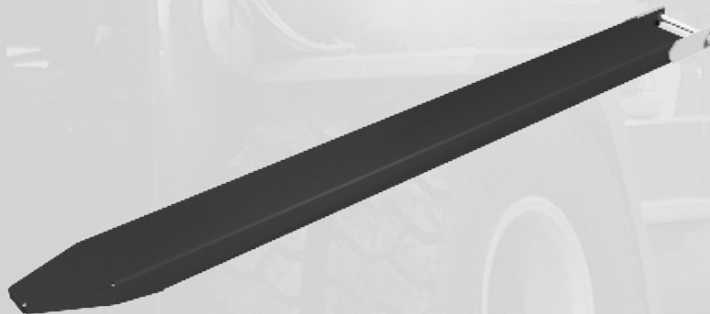

LOOSE FORK EXTENSIONS

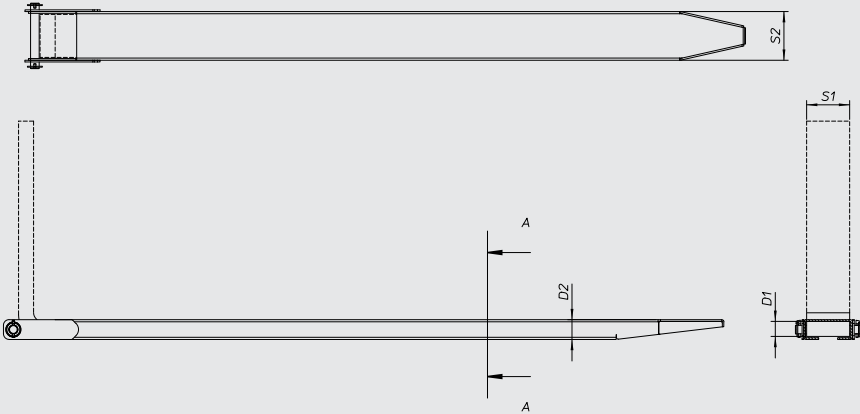

For applications with very infrequent need for differing fork lenght

Fork Extensions							
Model	Capacity on LC 600 mm (kg)	Section D1xS1 (mm)	Section D2xS2 (mm)	L (mm)	Sheet thickness (mm)	Weight (kg)	Extra weight /100 mm (kg)
E15-1600-035080	1500	35 x 80	46 x 93	1600	4	22	1,5
E18-1600-035100	1800	35 x 100	46 x 113			24	1,6
E24-1600-035130	2400	35 x 130	46 x 143			27	1,8
E19-1600-040080	1900	40 x 80	51 x 93	1600	4	23	1,5
E24-1600-040100	2400	40 x 100	51 x 113			25	1,6
E29-1600-040120	2900	40 x 120	51 x 133			27	1,8
E32-1600-040130	3200	40 x 130	51 x 143			28	1,9
E31-1600-045100	3100	45 x 100	56 x 113	1600	4	26	1,7
E37-1600-045120	3700	45 x 120	56 x 133			28	1,8
E39-1600-045125	3900	45 x 125	56 x 138			29	1,9
E40-1600-045130	4000	45 x 130	56 x 143			29	1,9
E38-1600-050100	3800	50 x 100	63 x 115	1600	5	35	2,2
E46-1600-050120	4600	50 x 120	63 x 135			37	2,4
E48-1600-050125	4800	50 x 125	63 x 140			38	2,4
E54-1600-050140	5400	50 x 140	63 x 155			40	2,6
E58-1600-050150	5800	50 x 150	63 x 165			41	2,6

- Insertion length should be a minimum of 60% for open and closed extensions.
- Capacities shown are nominal and apply to the forks and not the lift truck.
- The lift truck manufacturer must determine the combined KOOI-REACHFORKS® and lift truck capacity.
- Other capacities and dimensions on request.

The Mast Height Extension (MHE) attachment will allow you to add additional lift height to your current forklift trucks without changing the mast, (upright). By adding a Mast Height Extension to your existing lift truck the same lift-truck can then handle extra pallets at a higher level without a larger load centre being required. The MHE can also be used to improve under-door clearance issues allowing a truck to pass through whilst maintaining the ability to reach higher levels.

The Mast Height Extensions mounts to a standard FEM (ITA) type fork carriage and it allows the use of existing lift truck forks with full adjustability, (fork spread), within the MHE carriage frame.

The system simply requires a single hydraulic function and its sleek design provides excellent visibility with minimum lost load thickness. It's even available with quick-change mounting hooks for applications which only require occasional use or movement from one truck to another.

The Mast Height Extension offers the following advantages:

- Excellent visibility.
- Minimum lost load thickness.
- Existing lift trucks can be used.
- Lift truck forks can be moved sideways.

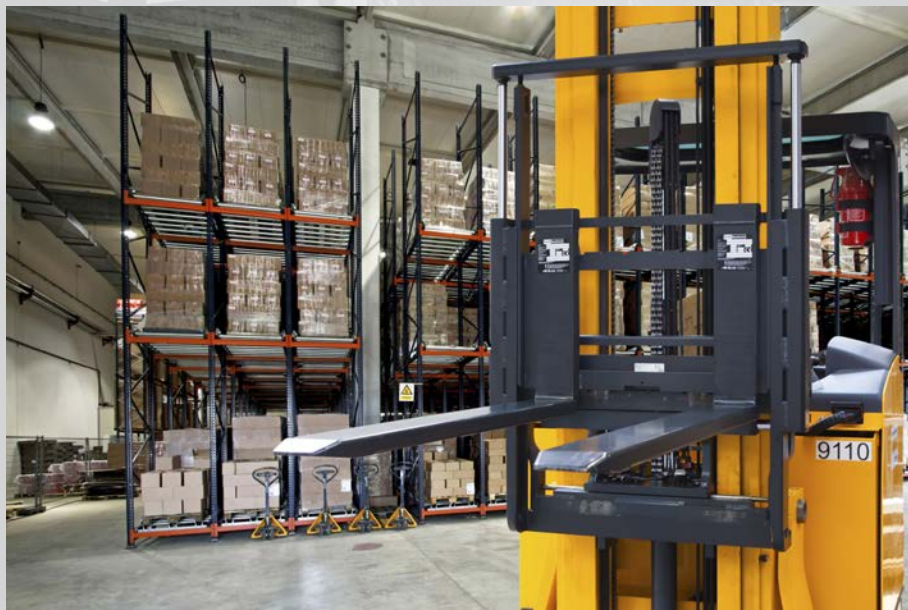

MAST HEIGHT EXTENSIONS

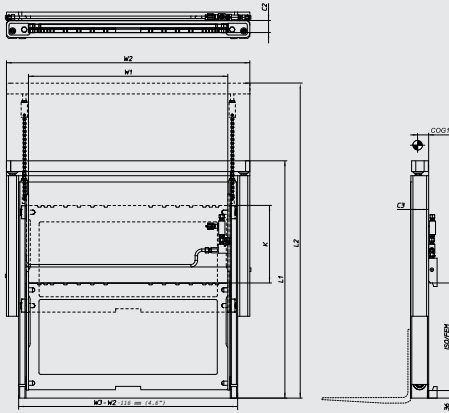

MHEH

Designed to adjust the height of a standard lift-truck mast.

- To handle extra pallets at a higher level.
- Improve visibility

Mast Height Extension - one hydraulic function needed.

Model	Capacity on LC 600 mm (kg)	Stroke (mm)	L1/L2 (mm)	W1 (mm)	W2 (mm)	C2 (mm)	C3 (mm)	CoG1 (mm)	CoGv1 (mm)	CoGv2 (mm)	Weight (mm)
MHEH 20 0300 550	2000	300	0820/1120	550	750	50	85	30	415	540	118
MHEH 20 0500 550		500	1020/1520					31	495	680	136
MHEH 20 0700 550		700	1220/1920					32	585	830	154
MHEH 20 1000 550		1000	1520/2520					33	720	1045	180
MHEH 20 0300 800	2000	300	0820/1120	800	1000	50	85	28	415	550	138
MHEH 20 0500 800		500	1020/1520					29	495	695	156
MHEH 20 0700 800		700	1220/1920					30	580	850	174
MHEH 20 1000 800		1000	1520/2520					32	710	1065	200
MHEH 30 0300 800	3000	300	0930/1230	800	1000	57	85	25	465	615	177
MHEH 30 0500 800		500	1130/1630					28	540	775	194
MHEH 30 0700 800		700	1330/2030					29	620	926	212
MHEH 30 1000 800		1000	1630/2630					30	745	1150	240
MHEH 30 0300 1000	3000	300	0930/1230	1000	1200	57	85	23	450	610	210
MHEH 30 0500 1000		500	1130/1630					25	530	770	230
MHEH 30 0700 1000		700	1330/2030					27	600	930	250
MHEH 30 1000 1000		1000	1630/2630					28	715	1163	280

- Possible in combination with KOOI-REACHFORKS®.
- Optional: quick change mounting hooks.
- The lift truck manufacturer must determine the combined Mast Height Extension and lift truck capacity.
- Capacities shown are nominal and apply to the attachment and not the lift truck. Other capacities and dimensions on request.
- Remark: When tilting mast carriage please contact Meijer Handling Solutions.

With the Single Height Shift system one of the two forks can be raised or lowered by 100 mm to compensate for the difference in height ensuring the safe loading and unloading of goods without damaging or moving off the forks when driving bumpy areas. Because the cylinders are fitted into the sides of the vertical sections of the forks, the system does not add anything to the front dimensions and the lift truck retains an optimum residual load capacity.

The Single Height Shift System (SHSSL) can be used on most any type of forklift including specialized lift trucks such as siders, rough terrain forklifts and mountable lift trucks, allowing these machines to deliver building materials safely and without damage.

When used in combination with KOOI-REACHFORKS® (hydraulic extendable forks) the Single Height Shift System can be operated for one sided loading and unloading but also one of the hydraulic forks can operate independently. Which makes the forklift truck much more flexible.

The Single Height Shift System offers the following advantages:

- Safe operation without damages in hilly and rough terrain.
- Minimum lost load thickness.
- Can be fitted to any type of forklift.



SINGLE HEIGHT SHIFT SYSTEMS



SHSSL

To compensate the difference in height without damaging the load.

Compensate bumps over rough terrain.

Single Height Shift System with standard lift truck forks - one hydraulic function										
Model	Capacity on LC 600 mm (kg)	Vertical movement up/down (mm)	W (mm)	H1 (mm)	C (mm)	CoGh (mm)	CoGv1 (mm)	CoGv2 (mm)	Weight (kg)	ISO/FEM
SHSSL 35.12-120/45	3500	100/100	270	1025	69	240	275	360	195	3B
SHSSL 45.12-120/50	4500	100/100	270	1025	69	255	265	355	210	3B
SHSSL 65.12-130/60	6500	100/100	280	1025	79	285	250	345	265	3B
SHSSL 58.12-150/50	5800	100/100	300	1025	69	248	260	350	257	3B
SHSSL 80.12-150/60	8000	100/100	300	1197	79	230	340	425	333	4B
SHSSL 77.12-200/50	7700	100/100	350	1197	69	235	330	420	372	4B

- Price includes standard lift truck forks. (two hydraulic functions needed).
- The lift truck manufacturer must determine the combined attachment and lift truck capacity.
- Capacities shown are nominal and apply to the attachment and not the lift truck. Other capacities and dimensions on request.

Meijer Handling Solutions knows the use of pallets for the storage of goods is unavoidable in a company. But what if you want to save time and space by sending your goods to the customer without using pallets? Meijer Handling Solutions introduces the **ROLLERFORKS®** which can be used for palletless handling. **ROLLERFORKS®** are in fact 'standard' lift truck forks with two layers of rollers. When the under most row of rollers touches the floor, it causes the uppermost rollers to rotate in the opposite direction whereby the forks slide under the slipsheet without disturbing the products. When the forks are lifted up, the rollers 'fall' downwards and place the products securely on the upper side of the forks, enabling the products to be unloaded in the opposite loading order.

ROLLERFORKS® are ideal for handling single-stacked good and offer the following unparalleled advantages over push-pull attachments:

- Less expensive.
- No hydraulics required.
- Higher-rated forklift truck unnecessary.
- Compatible with standard pallets.
- Improved safety and visibility.
- Higher operating speed.
- Reduced maintenance costs.
- Simplified handling procedures.
- No axial forces exerted.



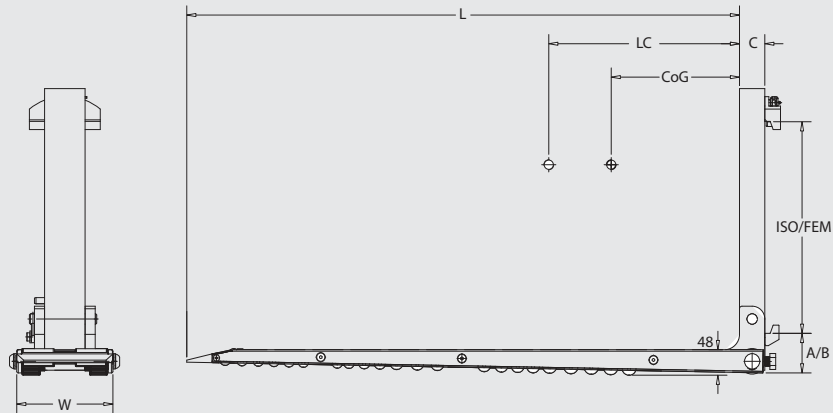

ROLLERFORKS®, no hydraulic required							
Model	Capacity on LC 500 mm (kg)	L (mm)	W (mm)	C (mm)	CoG (mm)	Weight (kg)	ISO/FEM
RFC 10-1100	1000	1100	190	50	343	130	2A
RFC 10-1200		1200			394	135	2A
RFC 15-1100	1500	1100	160	50	378	115	2A
RFC 15-1200		1200			325	123	2A
RFC 20-1100	2000	1100	210	60	337	147	2A
RFC 20-1200		1200			388	155	2A
RFC 24-1100	2400	1100	210	60	332	151	2A
RFC 24-1200		1200			383	160	2A
RFC 30-1100	3000	1100	310	60	320	255	3A
RFC 30-1200		1200			373	270	3A

RollerForks® for refrigerated containers

RFCC 10-1100	1000	1100	250	50	380	130	2A
RFCC 10-1200		1200			420	138	2A
RFCC 20-1100	2000	1100	270	60	349	160	2A
RFCC 20-1200		1200			385	171	2A
RFCC 24-1100	2400	1100	270	60	349	164	2A
RFCC 24-1200		1200			391	176	2A

Options

Foldable palletstop to reduce the blade length. Retracted 50 mm, extended 200 mm

ROLLERFORKS® (RFCH, RFCCH) with a heavy solid duty taper, 240 HB.

Tube welded on the fork back to reduce the length (when length is shorter than 1000 mm).

This hydraulic forklift attachment is used for handling multiple stacked goods and comes with only one function to operate the faceplate and gripper. The Meijer Handling Solutions push-pull attachment is made up of laser cut components making the attachment less in weight but keeping the strength of using solid material.

The push-pull attachment is the perfect solution for when the standard lift truck needs to be converted to a slip sheet forklift. Meijer Handling Solutions offers two different push-pull attachment principles:

- carriage mounted push-pull
- fork mounted push-pull

The carriage mounted push-pull is hooked onto the forklift carriage. The system is most appropriate in a situation where a company has a constant need for a slip sheet forklift because containers are loaded and unloaded frequently during the day.

The fork mounted push-pull is adapted onto the existing forklift truck forks. This system is most appropriate when companies load or unload containers once in a while with their existing forklift truck.



PUSH-PULLS

Palletless handling of multi-stacked goods

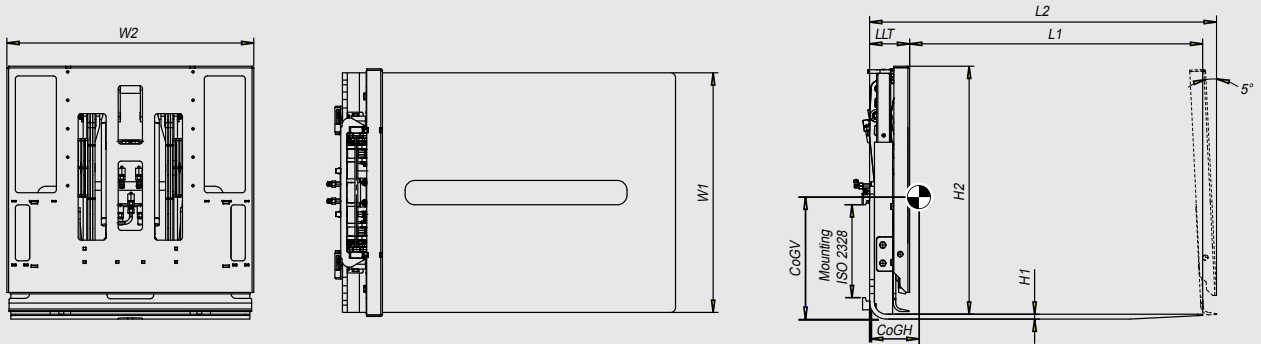

Carriage mounted Push-Pull, one hydraulic function needed

Model	Capacity on LC 600 mm (kg)	W1 (mm)	W2 (mm)	W3 (mm)	LLT (mm)	L2 (mm)	L1 (mm)	H1 (mm)	H2 (mm)	CoGh (mm)	ISO/ FEM	Weight (kg)
PP-SM16-12P-10	1600	985	1018		170	1380	1200	20	1020	305	II	470
PP-SM20-12P-10	2000	985	1018		170	1380	1200	20	1020	305	II	470

- Recommended pressure at least 130 bar and recommended flow 10 l/min.
- Optional quick change coupling and change carriage hooks.

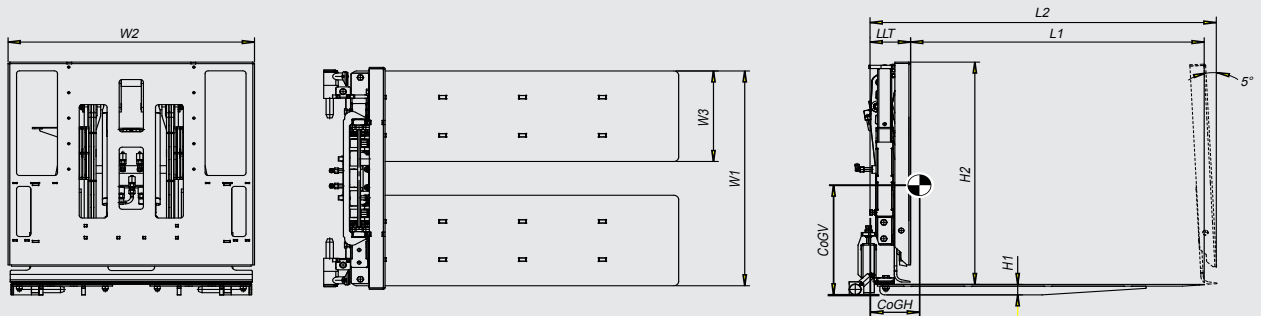

Fork mounted Push-Pull, one hydraulic function needed

Model	Capacity on LC 600 mm (kg)	W1 (mm)	W2 (mm)	W3 (mm)	LLT (mm)	L2 (mm)	L1 (mm)	H1 (mm)	H2 (mm)	CoGh (mm)	ISO/ FEM	Weight (kg)
PP-SQ16-12P-10	1600	985	1018	415	167	1380	1200	8	1020	140	Q	350
PP-SQ20-12P-10	2000	985	1018	415	167	1380	1200	10	1020	165	Q	362

- Recommended pressure at least 130 bar and recommended flow 10 l/min.
- Mounting on standard lift truck forks with a maximum thickness of 45 mm and length 1100 mm.
- Optional quick change coupling.

This innovation combines the cost-saving benefits of ROLLERFORKS® along with proven push-pull technology creating a revolutionary pallet-less handling solution. The ROLLERFORKS® Push-Pull is a system made up of one or two face-plate unit(s) with RollerForks® instead of platens. A standard fork positioning system allows the RollerForks® to move sideways hydraulically. Therefore, it is an ideal attachment for handling differently sized slipsheeted goods as well as different sized pallets.

By using the unique ROLLERFORKS® Push-Pull attachment combo, it is now possible to load and unload containers and/or trailers with loads stacked on top of one another faster than ever before. The

innovative system is nearly twice as fast as conventional push-pull systems!

The ROLLERFORKS® Push-Pull offers the following advantages:

- Ideal for handling single and multiple stacked goods.
- Improved handling speed lowers cycle time and cost.
- Offers versatility for use with standard pallets as well as pallet-less loads.
- Fork width can be adjusted to provide the best possible load stability.



ROLLERFORKS® PUSH-PULLS

Palletless handling of single and multi-stacked goods

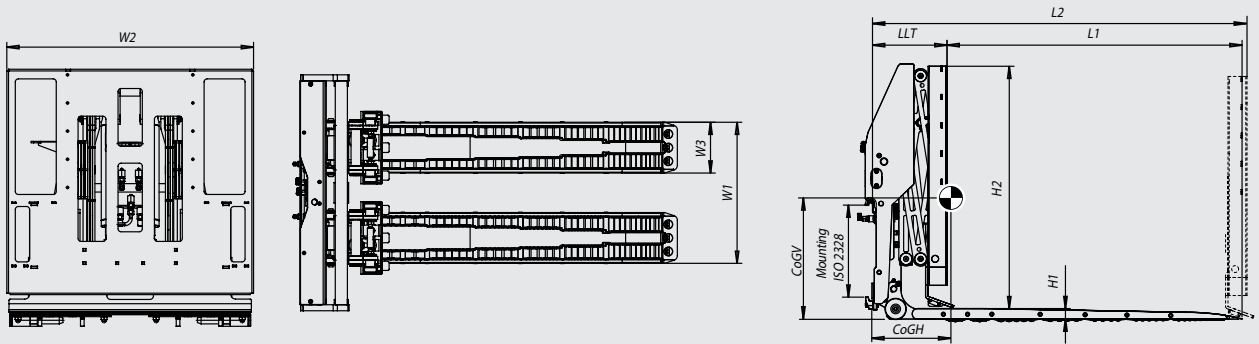

ROLLERFORKS® Push/Pull, two hydraulic functions needed

Model	Capacity on LC 600 mm (kg)	W1 (mm)	W2 (mm)	W3 (mm)	LLT (mm)	L2 (mm)	L1 (mm)	H1 (mm)	H2 (mm)	CoGh (mm)	ISO/ FEM	Weight (kg)
PP-SM17-12R-FS-10	1700	580-850	1018	210	295	1545	1250	50	1020	595	II	543
"Cold storage application"												
PP-SM17-12RC-FS-10	1700	640-910	1018	270	295	1545	1250	50	1020	575	II	534

- Fork positioner included.
- Recommended pressure at least 160 bar and recommended flow 10 l/min.
- Optional 8/3 valve and quick change.

The Rollerized Tine Extender (RTE) is specifically developed for handling air cargo pallets. Examples of such pallets are: 463L, HCU-6/E or PMC cargo pallets used for military and civil transport. These standardized pallets are used for transporting air cargo.

Rollerized Tine Extenders are used for forklift trucks and easily slip onto existing lift truck forks transforming the forks into a roller cargo platform.

Rollerized Tine Extenders consist of a hollow cross-section with a single layer of rollers on each side. They can be fitted to regular forklift truck tines like a sleeve and secured using locking pins. Used

in this way, the rollers are unable to descend so the load remains seated on the rollers at all times. Rollerized Tine Extenders have been fitted with a stop to prevent the load sliding off the rollers whenever the forklift truck brakes. The load can be pushed or rolled off the forks manually if the mast is tilted forwards and the stops have been folded out of the way. On special request, Rollerized Tine Extenders are available in various types and ratings.



ROLLERIZED TINE EXTENDERS

Air cargo pallets

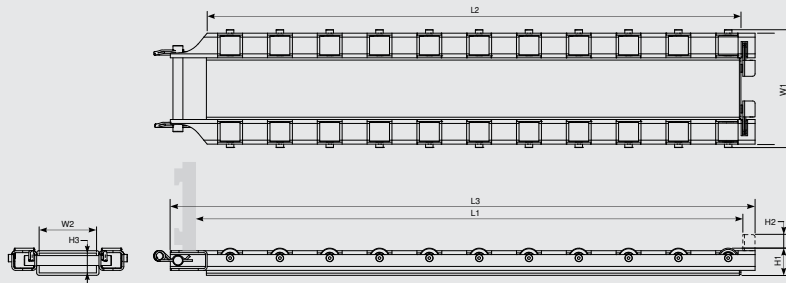

RTE

For handling air cargo pallets.
- Mostly used by US-Army
and other Defence Forces.

Model	Capacity on LC 600 mm (kg)	W1 (mm)	W2 (mm)	L1 (mm)	L2 (mm)	L3 (mm)	H1 (mm)	H2 (mm)	H3 (mm)	Weight (kg)
RTE 50-1850	5000	400	160	1850	1900	2078	110	65	75	340
RTE 50-2250				2250	2300	2478				408
RTE 50-2450				2450	2500	2678				442
RTE 50-2750				2750	2800	2978				496
RTE 50-3150				3150	3200	3378				564
RTE 80-1850	8000	480	230	1850	1900	2078	110	65	80	442
RTE 80-2250				2250	2300	2478				510
RTE 80-2450				2450	2500	2678				544
RTE 80-2750				2750	2800	2978				598
RTE 80-3150				3150	3200	3378				666

- Optional rubber bump-stoppe.
- Other capacities and dimensions on request.

The Stationary Pallet Changer, (SPC) is a remote-controlled efficient and compact stand-alone unit which provides excellent performance. It's ideal for applications where goods need to be transferred from wooden to plastic pallets or vice-versa. The stationary pallet changer is mainly used in industries where some products, i.e. liquids, cannot be inverted as this would cause problems with validation or in industries where goods are packed in fragile packaging materials.

The pallet changer allows companies currently using manual labor to drastically reduce operational costs and avoid injury risks and it provides an affordable alternative to more complex transfer systems.

Compared to pallet inverters the Stationary Pallet Changer offers the following advantages:

- Improved handling speed
- No clamping of goods
- No inversion of load
- Simple construction
- Less maintenance because of no rotation parts
- Faceplate speed reduction for end positions
- Remote controlled
- Plug & play



STATIONARY PALLET CHANGERS

Transferring goods from one load carrier onto another load carrier

SPC20/1220/B

SPC20/1220/S

SPC20/1220/D

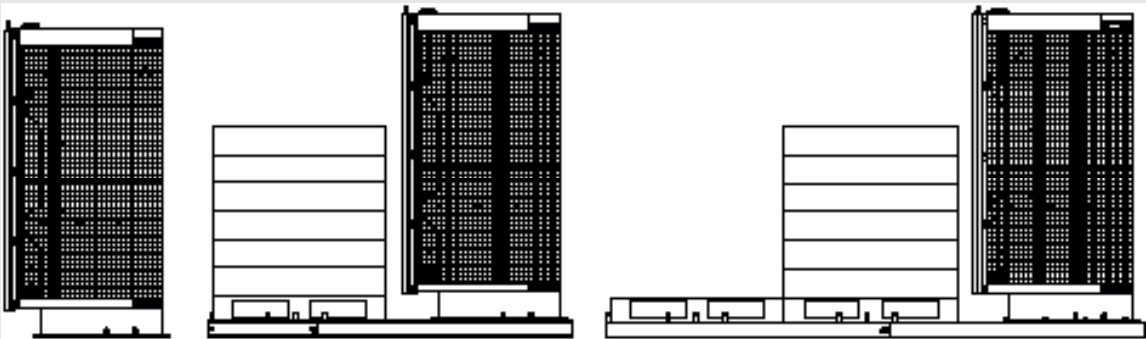

Model	Capacity (kg)	L (mm)	H (mm)	Width (mm)	Power Supply	Faceplate speed	A (mm)	Weight (kg)	Safety Circuit
SPC20/1220/B	2000	1171	2192	1100	3ph/400V/16A/50Hz or	7-16 sec	185	1041	CAT3/PLd
SPC20/1220/S		2571	2307	1200				1477	
SPC20/1220/D		3790	2307	1200				1681	

Options

Warning buzzer
Warning beacon light (LED)
Warning oil level and temperature.
Option - Thin Loading Platform (TLP) in combination with SPC20/1220/B
Galvanised - single version
Galvanised - double version
Stainless steel - single version
Stainless steel - double version

Optional Octabin adapter

Mostly used for liquids and granulates



Other capacities, dimensions, voltages, amperes, etc. on request.

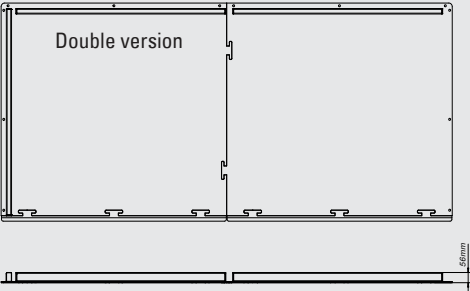
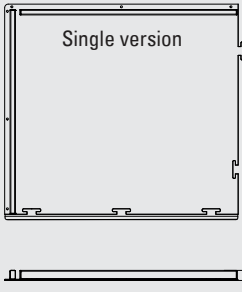

The stand-alone Stationary “Push/Pull”, SPI, provides a highly efficient and cost effective means of transferring unit loads from one load carrier to another. It's especially useful for keeping wooden pallets outside of cleanroom areas in order to comply with hygiene regulations.

Cost saving benefits:

- Reduce contamination risks.
- Avoid unnecessary costs (eliminate the need for an additional forklift).
- Reduce product damage (no pushing forces and no clamping forces on goods).
- Improve throughput rate (stationary placement for standardized process).
- Lower operational costs (low maintenance and low energy consumption).

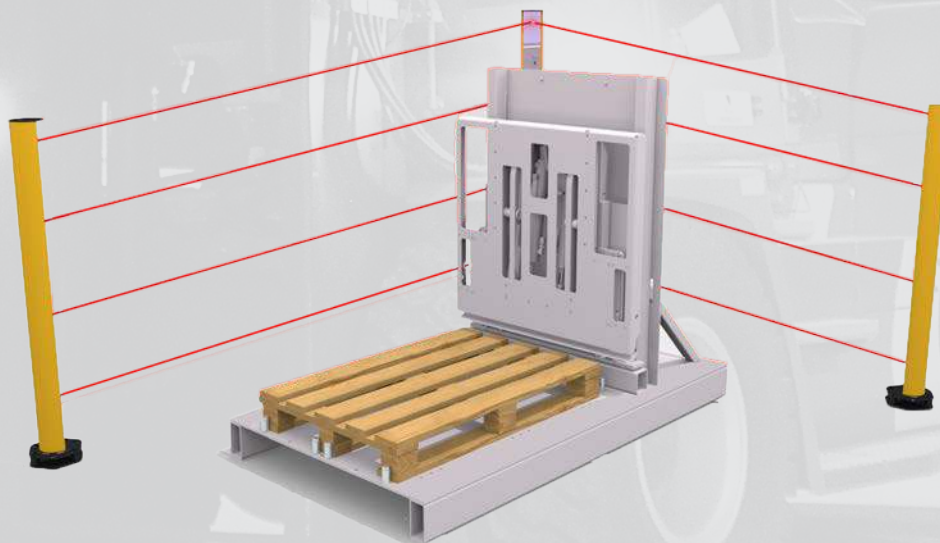

STATIONARY PULL INSTALLATION

Transferring goods from one load carrier onto another load carrier

SPI10/1220

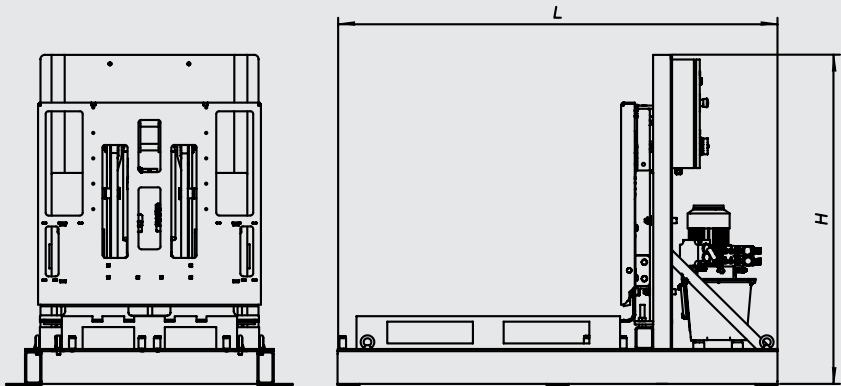

SPI

Used to transfer goods from one load carrier to another within a cleanroom.

Model	Loading Capacity (kg)	L (mm)	H (mm)	Width (mm)	Power Supply	Weight (kg)	Safety Circuit
SPI10/1220	1000	2000	1515	1305	3ph/400V/16A/50Hz or 3ph/208V/16A/60Hz	790	CAT3/PLd

Standard options

Warning buzzer
Warning beacon light (LED)
Warning oil level and temperature.
Full surround safety light curtain
Galvanised or stainless steel construction parts
Other voltages, amperes and capacities on request

MEIJER

HANDLING SOLUTIONS

Oudebildtdijk 894
9079 NG Sint Jacobiparochie
The Netherlands
www.meijer-group.com
info@meijer-group.com

KOOI

REACHFORKS®

KOOI

EQUIPMENT®

KOOI

PALLETLESS®

KOOI

SYSTEMS®

CATALOG 2016

MEIJER